

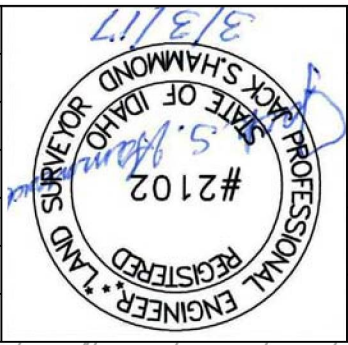

HAMMOND ENGINEERING & DEVELOPMENT CO.
528 BRYDEN AVENUE LEWISTON, IDAHO 83501
(208) 736-5422

THE ESTATES AT CANYON CREST - PHASE III/ PROJECT IIIA
RPL DEVELOPMENT CO., INC.
LEWISTON, IDAHO

DRAWING #	1650-C4
SHEET	C4
DATE	03-03-17
JOB #	1650
DRWNR	MEE
CHECKED BY	JSH
SCALE	1"=40'
SHEET SIZE	D



REV	DATE	DESCRIPTION	CHECKED	APPD.
B	05-22-17	Revised as per city review comments dated 4-05-2017		
AB	10-30-17	As-built data		

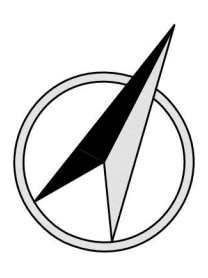
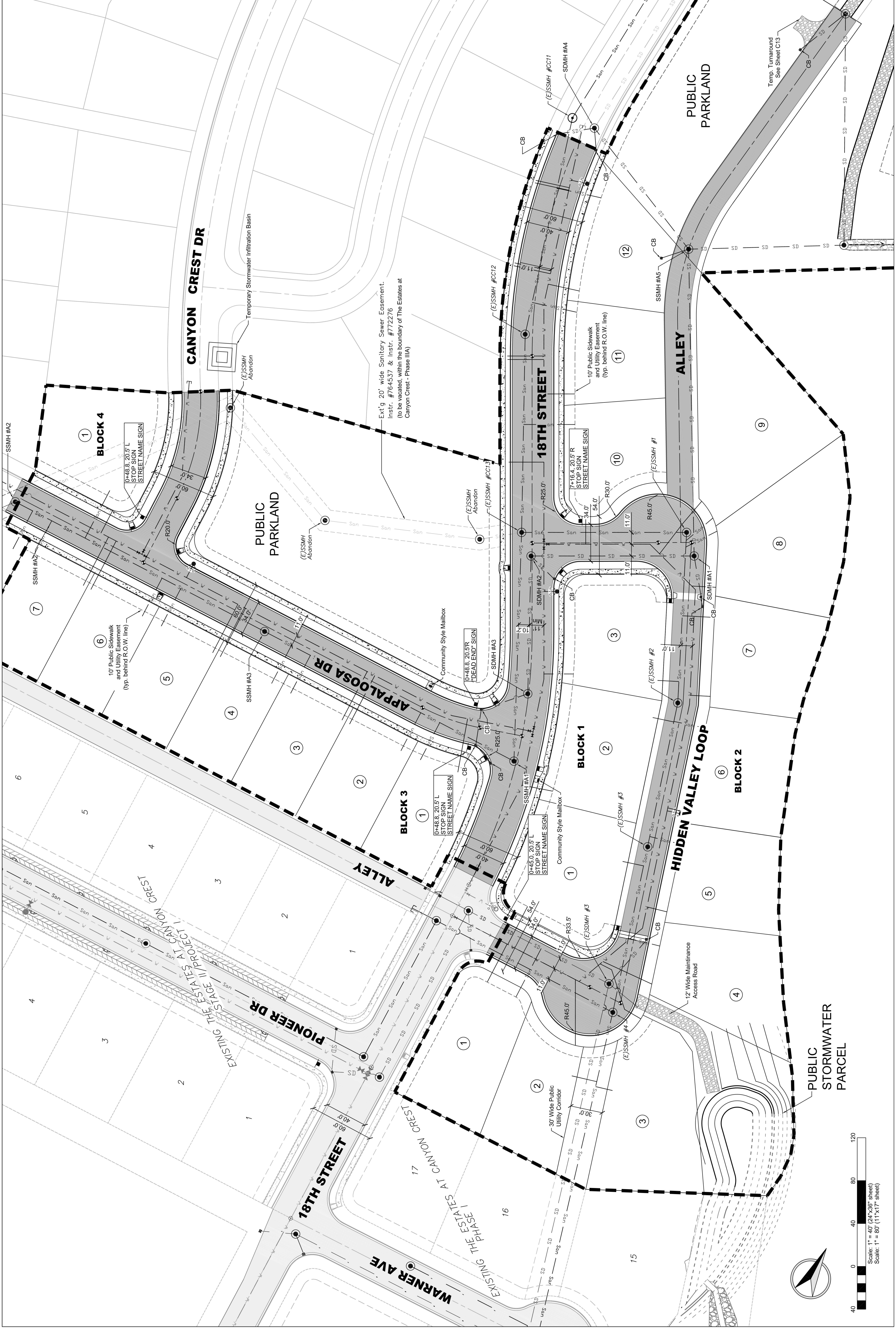

Ext'g 20' wide Sanitary Sewer Easement.
Instr. #764537 & Instr. #772276
(to be vacated within the boundary of The Estates at
Canyon Crest - Phase IIIA)

10' Public Sidewalk
and Utility Easement
(typ. behind R.O.W. line)

10' Public Sidewalk
and Utility Easement
(typ. behind R.O.W. line)

12' Wide Maintenance
Access Road

Temp. Turnaround
See Sheet C13

EXISTING THE ESTATES AT CANYON CREST
PIONEER DR

EXISTING THE ESTATES AT CANYON CREST
WARNER AVE