

NOTE:
ALL CONSTRUCTION TO BE IN ACCORDANCE WITH IDAHO STATE STANDARDS FOR PUBLIC WORKS. (ISPWC).

SNAKE RIVER AVENUE WATER LINE

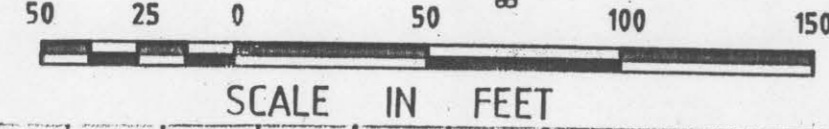

LEGEND

- MANHOLE PROPERTY CORNER - FOUND 5/8" BY 30" REBAR / CAP.
- UTILITY LINE ANGLE POINT - NOT SET.
- PROPOSED LOT CORNER - NOT SET.
- TELEPHONE STAND.
- STORM WATER BASIN INLET - EXISTING.
- CENTERLINE ROAD COURSE CHANGE - FOUND BRASS CAP IN CASE.
- WATER LINE VALVE CASE - EXISTING
- STREET LIGHT - EXISTING.
- POWER POLE - EXISTING
- CULVERT EXISTING.
- ROAD CENTERLINE
- EASEMENT LINE
- W/L - WATER LINE - EXISTING.
- G/L - GAS LINE - EXISTING.
- E/L - ELECTRIC LINE UNDERGROUND - EXISTING.
- EXISTING STORM DRAIN.

BENCH MARKS - SEA LEVEL		
T.B.M. # & IDENT.	ELEV.	ELEV. TOP C/G
1 PROP. COR.	778.70'	
2 LIGHT POLE - TOP ELECT. BOX	790.06'	789.07'
3 " " "	802.40'	800.85'
4 " " "	816.26'	815.29'
5 " " "	829.73'	828.14'
6 " " "	841.79'	840.74'
7 " " "	854.40'	853.33'
8 " " "	867.26'	866.07'
9 " " "	879.53'	878.58'
10 " " "	893.07'	891.84'
11 " " "	906.24'	905.16'

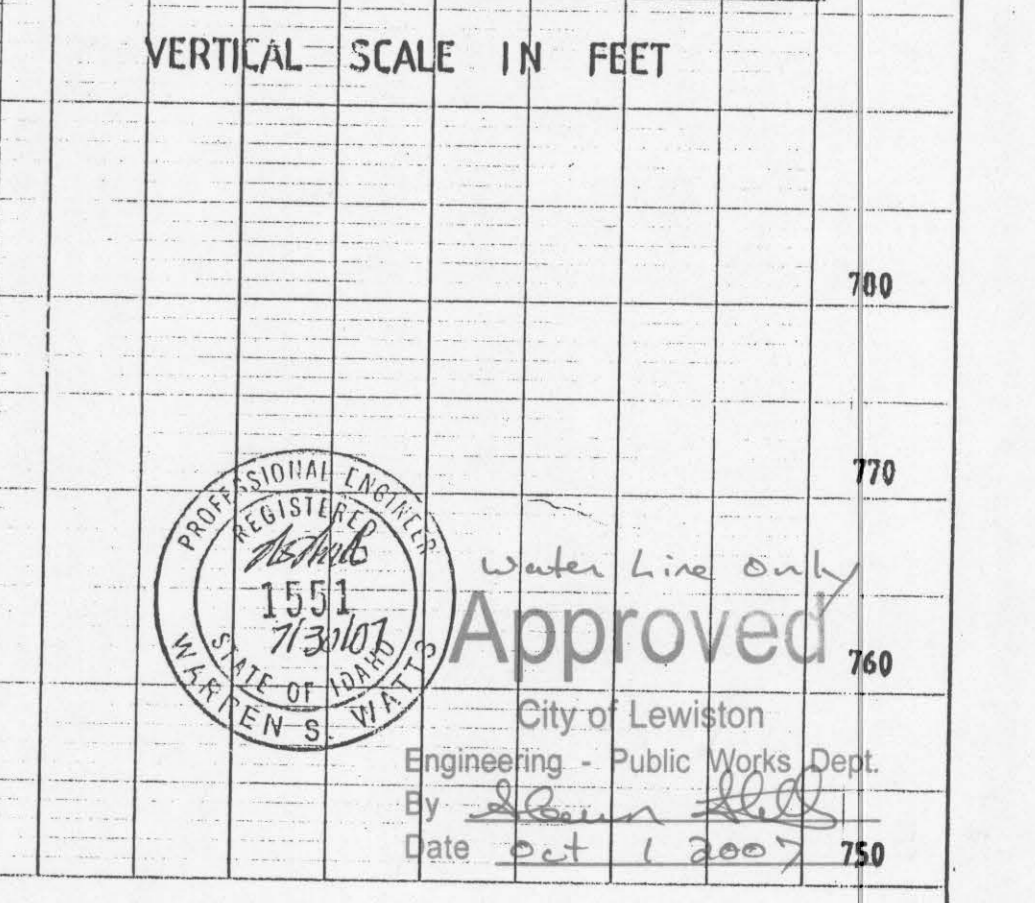
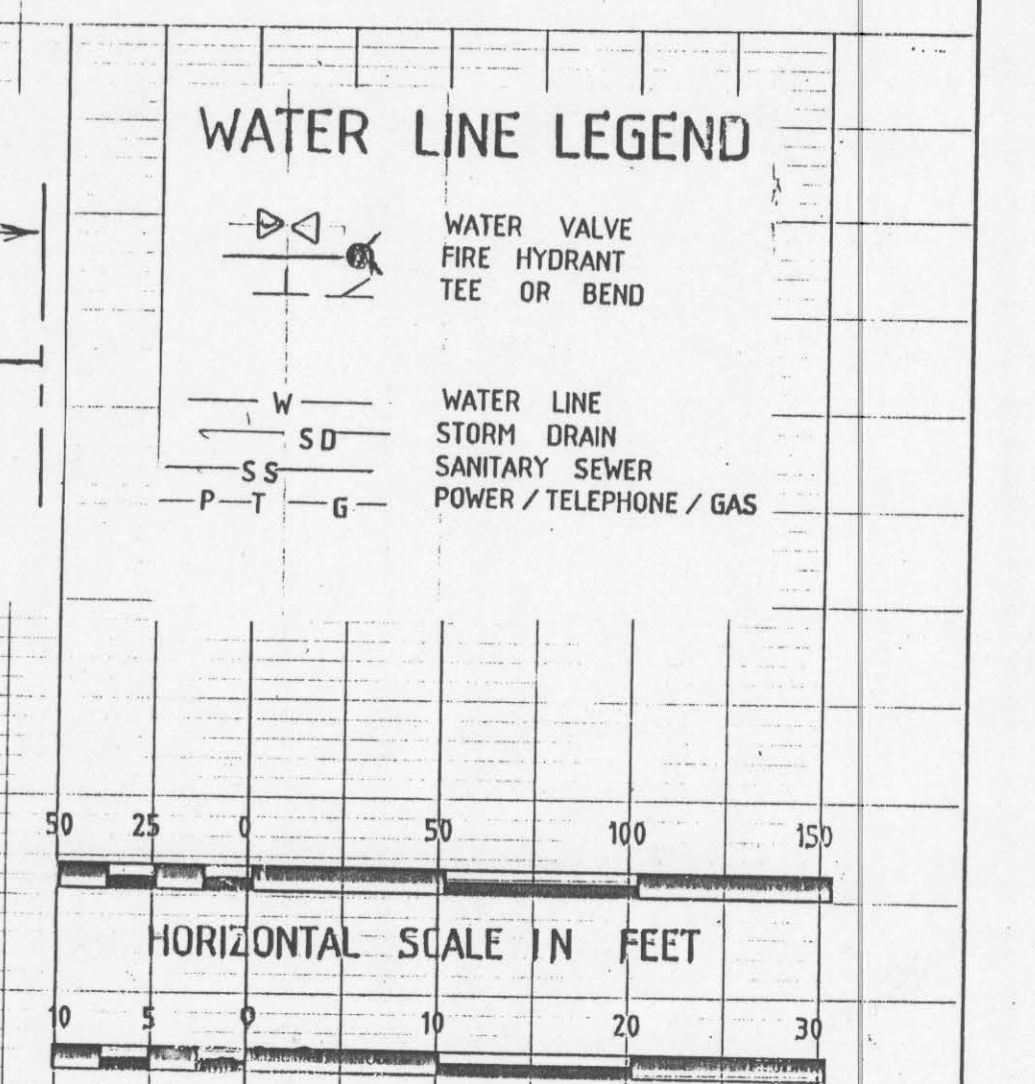
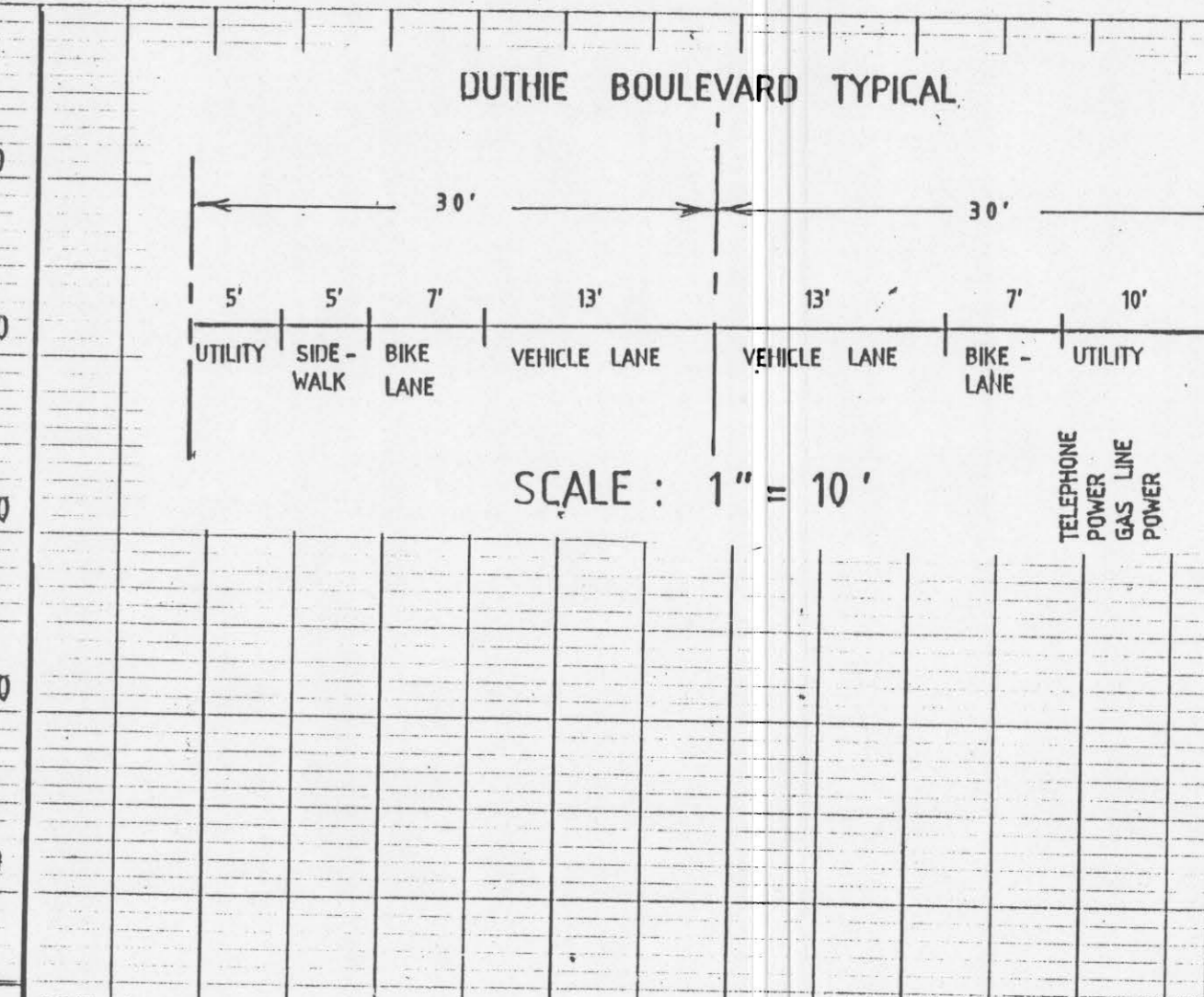
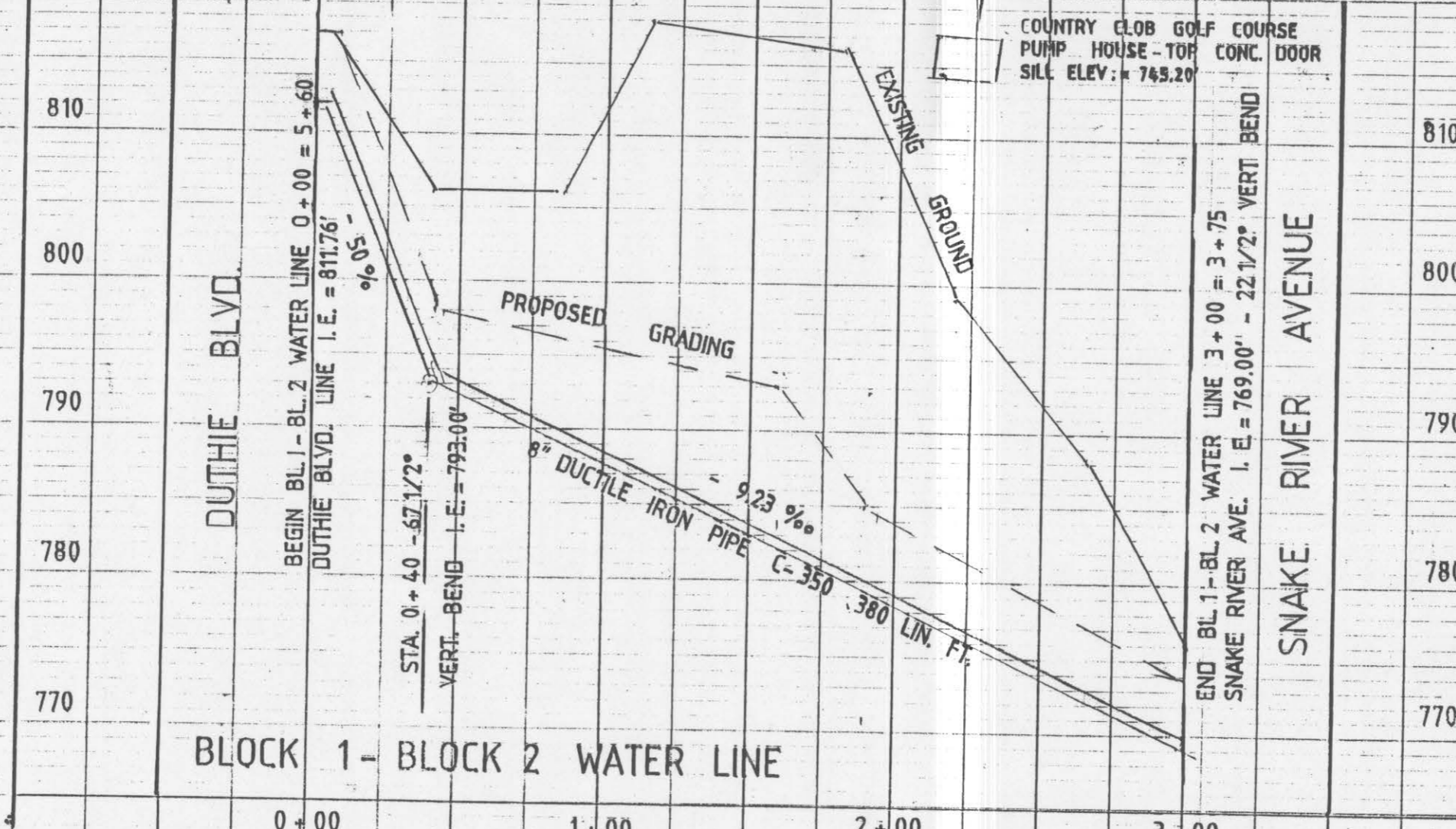

PROFESSIONAL ENGINEER
1551
Water Line Only
Approved
City of Lewiston
Engineering - Public Works Dept.
By *[Signature]*
Date Oct 1 2007