

IMPROVEMENT PLANS

NEZ PERCE DRIVE LEWISTON, IDAHO 83501

AGENCY TELEPHONE NUMBERS

CITY OF LEWISTON BUILDING INSPECTION CONTACT: KATIE HOLLINGSHEAD OR DAWN ORTIZ	(208) 746-1318 EX 7263 DAWN EX 7203 KATIE
CITY OF LEWISTON WATER & SEWER CONTACT: BRYAN LACY	(208) 746-1316
CITY OF LEWISTON PUBLIC WORKS DEPT. CONTACT: SHAWN STUBBERS	(208) 746-1316
AVISTA UTILITIES CONTACT: TED BOYLE	(208) 798-1473
CENTURY LINK CONTACT: JULIO MENDEZ	(208) 798-8380
CABLE ONE CONTACT: DAN SMITH	(208) 746-3336 EX 3 DAN
NEZ PERCE COUNTY ROAD DEPT. CONTACT: MARK RIDINGER	(208) 799-3060
UNDERGROUND UTILITY LOCATE (CALL 48 HOURS BEFORE YOU DIG)	1-800-342-1585 or call 811
DEVELOPER: JOE & FRANCES MCCANN FAMILY LIMITED PARTNERSHIP 202 26TH AVENUE LEWISTON, ID 83501	
CONTACT: PAT McCANN	(208) 791-6573



LEGEND

---(XXX)---	EXISTING CONTOUR	---XXX---	PROPOSED CONTOUR
---SS---	EXISTING SANITARY SEWER	---SS---	PROPOSED SANITARY SEWER
---P-SS---	EXISTING PRESSURIZED SEWER	---P-SS---	PROPOSED PRESSURIZED SEWER
---W---	EXISTING DOMESTIC WATER	---W---	PROPOSED DOMESTIC WATER
---IR---	EXISTING IRRIGATION WATER	---WS---	PROPOSED DOMESTIC WATER SERVICE
---SD---	EXISTING STORM DRAIN	---SD---	PROPOSED STORM DRAIN
---O/P---	EXISTING OVERHEAD POWER	---P.G.T.C---	PROPOSED UNDERGROUND UTILITIES
---GAS---	EXISTING GAS LINE	---GAS---	PROPOSED GAS LINE
[Hatched Box]	EXISTING A.C.	[Dotted Box]	PROPOSED A.C.
[Stippled Box]	EXISTING CONCRETE	[Cross-hatched Box]	PROPOSED CONCRETE
[Grained Box]	EXISTING GRAVEL	[Cross-hatched Box]	PROPOSED GRAVEL
⊙	EXISTING SEWER MANHOLE	⊙	PROPOSED SEWER MANHOLE
⊙	EXISTING STORM DRAIN MANHOLE	⊙	PROPOSED STORM DRAIN MANHOLE
■	EXISTING CATCH BASIN	■	PROPOSED CATCH BASIN
⊕	EXISTING GATE VALVE	⊕	PROPOSED GATE VALVE
⊕	EXISTING WATER METER	⊕	PROPOSED WATER METER
⊕	EXISTING FIRE HYDRANT	⊕	PROPOSED FIRE HYDRANT
---	EXISTING EDGE OF ASPHALT	---	PROPOSED EDGE OF ASPHALT/SIDEWALK/CURB/GUTTER
---	EXISTING RIGHT-OF-WAY	---	NEW RIGHT-OF-WAY DEDICATION
---	EXISTING CENTER LINE	---	PROPOSED CENTER LINE OF STREET
---	EXISTING FENCE		
---	EXISTING SECTION LINE		
⊙	EXISTING MONUMENT	⊙	PROPOSED MONUMENT
⊕	EXISTING SECTION CORNER		
⊙	EXISTING PROPERTY CORNER		

VICINITY MAP

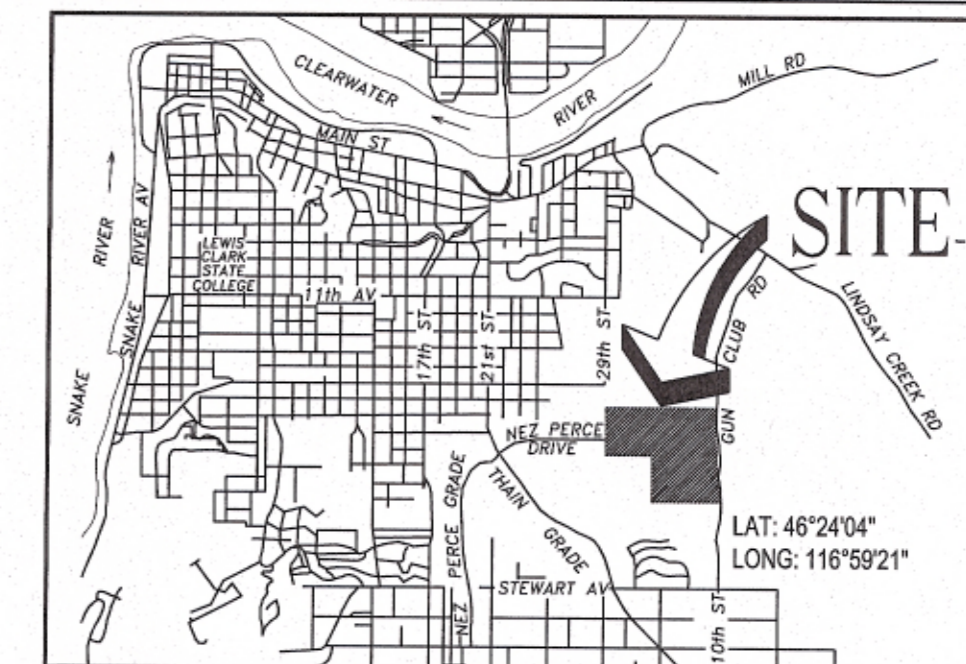

SHEET INDEX

SHEET C1	COVER SHEET
SHEET C2	CONSTRUCTION NOTES #1
SHEET C3	CONSTRUCTION NOTES #2
SHEET C4	TEMPORARY EROSION & SEDIMENT CONTROL
SHEET C5	ALIGNMENT & PROFILE NEZ PERCE DRIVE
SHEET C6	INTERSECTION DETAILS
SHEET C7	GRADING ALIGNMENT & PROFILE GUN CLUB ROAD
SHEET C8	TYPICAL SECTIONS
SHEET C9	CROSS SECTIONS 10+00 TO 25+00
SHEET C10	CROSS SECTIONS 25+50 TO 29+00
SHEET C11	CROSS SECTIONS 29+50 TO 33+50
SHEET C12	CROSS SECTIONS 34+00 TO 37+00
SHEET C13	QUANTITIES
SHEET C14	UTILITIES STA 10+00 TO 14+50
SHEET C15	UTILITIES STA 14+50 TO 19+00
SHEET C16	UTILITIES STA 19+00 TO 22+50
SHEET C17	UTILITIES STA 22+50 TO 28+50
SHEET C18	UTILITIES STA 28+50 TO 33+50
SHEET C19	UTILITIES STA 33+50 TO 37+50
SHEET 19A	PRV VAULT DETAILS
SHEET C20	STRIPING STA 10+00 TO 21+00
SHEET C21	STRIPING STA 21+00 TO 32+50
SHEET C22	STRIPING INTERSECTION NPD AND GUN CLUB ROAD
SHEET C23	20 ACRE FILL SITE - GRADING & DRAINAGE
SHEET C23A	WEST STORM DRAIN POND
SHEET C24	TRAFFIC CONTROL NPD AND JUNIPER INTERSECTION
SHEET C25	TRAFFIC CONTROL GUN CLUB RD
SHEET C26	CONSTRUCTION DETAILS
SHEET C27	CITY STANDARD DETAILS - GENERAL
SHEET C28	CITY STANDARD DETAILS - CONCRETE
SHEET C29	CITY STANDARD DETAILS - CONCRETE, STREET, WATER
SHEET C30	CITY STANDARD DETAILS - WATER, WASTEWATER
SHEET C31	CITY STANDARD DETAILS - WASTEWATER, STORMWATER
SHEET C32	CONSTRUCTION & CITY STANDARD DETAILS

RIGHT OF WAY PERMIT QUANTITIES

PAVED AREA IN ROW	± 126,656	S.F.
APPROACH WIDTH @ ROW	± 0	L.F.
TRENCH LENGTH	± 8462	L.F.
STREET CUT LENGTH/WIDTH	± 885	L.F.
C/G/SW LENGTH	± 5381	L.F.
MAIN LINE LENGTH	± 6292	L.F.

UTILITY PERMIT QUANTITIES

BASE FEE	1	EA
CATCH BASIN	20	EA
MANHOLE	7	EA
DOMESTIC WATER LINE	± 3176	L.F.
WASTE WATER LINE	± 1220	L.F.
STORM DRAIN LINE	± 2717	L.F.

DATE BY DESCRIPTION

COVER SHEET
NEZ PERCE DRIVE
JUNIPER TO GUN CLUB ROAD
LEWISTON, ID. 83501

KELTIC ENGINEERING, INC.
315 Adams Lane • Lewiston, Idaho 83501 • (208) 743-2135 • (208) 743-2136 fax
9425 North Nevada Street, Ste 204 • Spokane, WA 99218 • (509) 464-3000 • (509) 464-3005 fax
• Development • Planning • Design • Construction Management

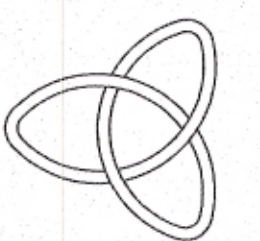

DRAWN BY: TWM
DESIGNED BY: EFH
DATE: 12/10/18
PROJECT NO.: 16-0001
SHEET NO.: C1 OF C32

RECORD DRAWING 12-10-18