

Drawing Name: Port of Lewiston		Drawn By: Ron Glessner 09-26-18	
248 THAIN RD			
SIZE	FSCM NO	DWG NO	REV
SCALE		SHEET 1	

REV.	DESCRIPTION	DATE	BY

Contact Information
 Port of Lewiston
 Dave Doeringsfeld
 208-743-5531
 Outside Plant Maintenance, llc
 Ron Glessner 208-661-5648

State: ID
 County: Nez Perce
 City: Lewiston
 Section:
 Township:
 Range:
 Legal:



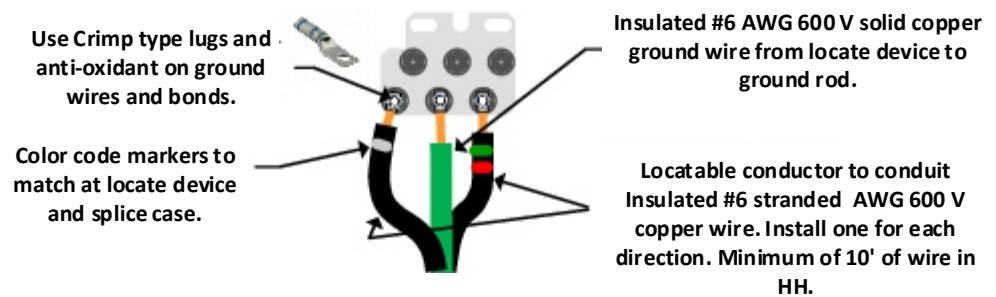
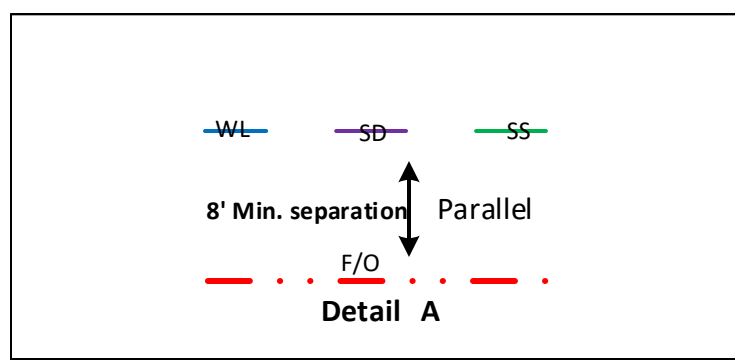
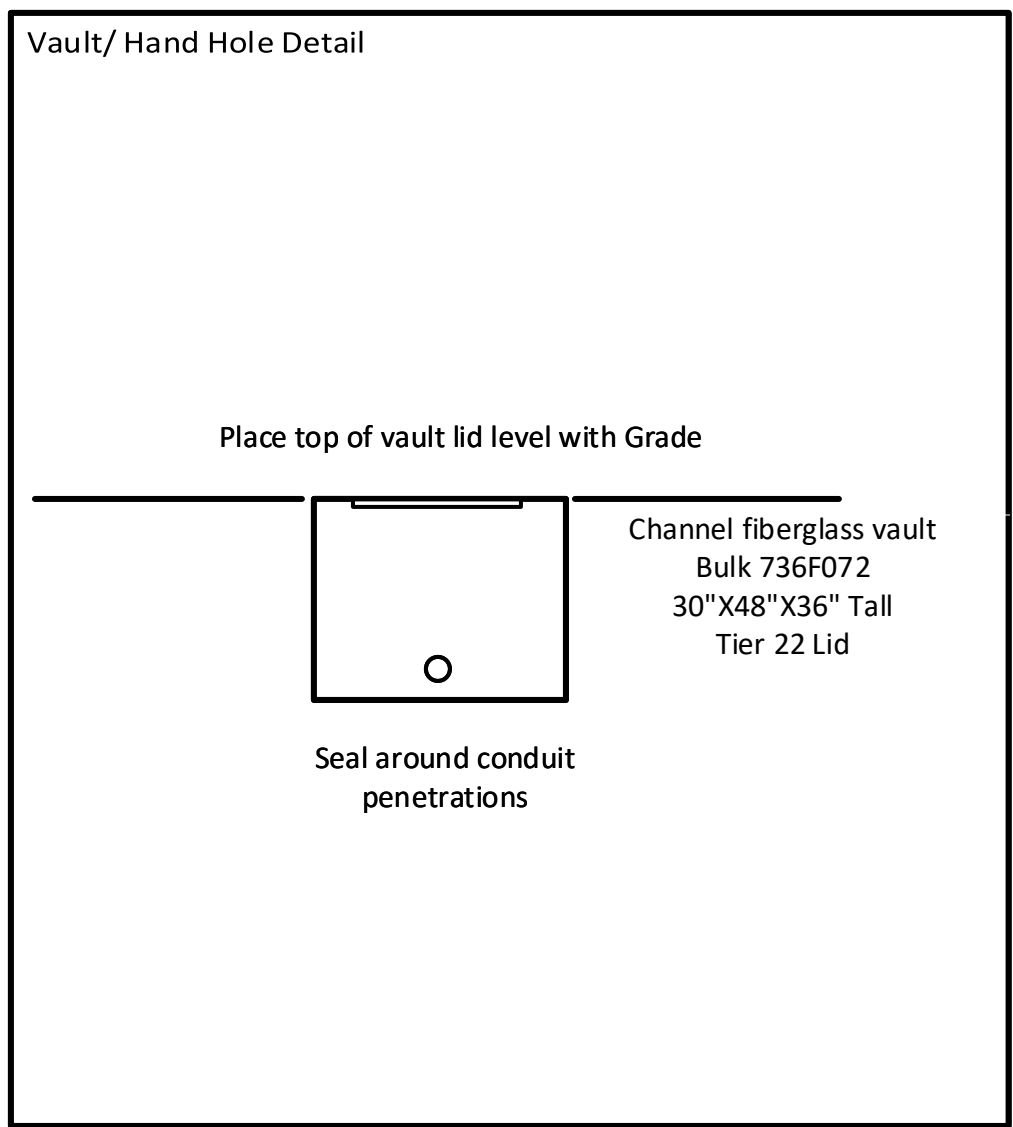
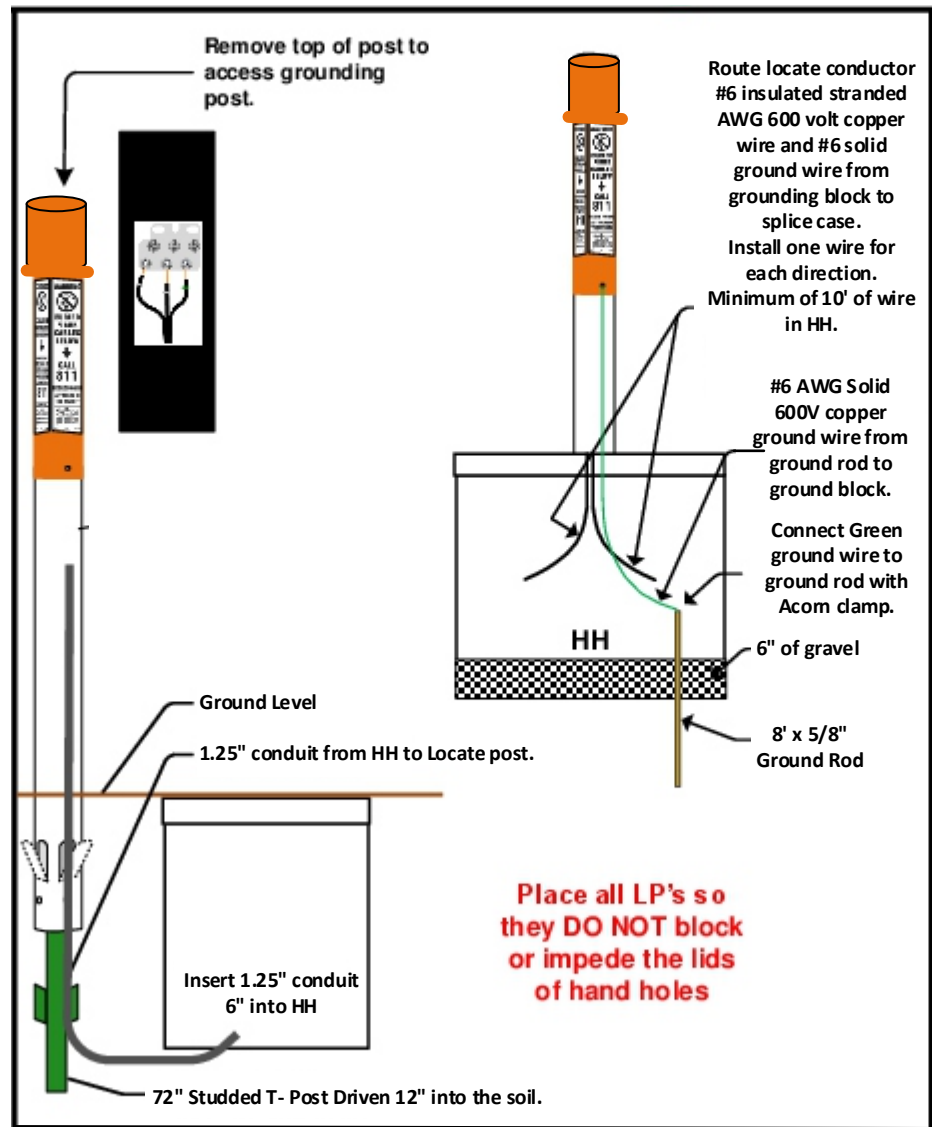

Drawn By: Ron Glessner 09-26-18			
248 THAIN RD			
SIZE	FSCM NO	DWG NO	REV
SCALE			SHEET 2

REV.	DESCRIPTION	DATE	BY

Contact Information	State: ID County: NEZ PERCE City: LEWISTON
	Section: Township: Range: Legal:
Outside Plant Maintenance, llc Ron Glessner 208-661-5648	



FIBER	CONSTRUCTION
0'	AERIAL 48 STRAND F.O.CABLE
830'	Buried 48 STRAND F.O.CABLE
455'	1 1/4" HDPE CONDUIT
0'	3" SCHEDULE 40 RISER
0	NEW ANCHOR
0	AERIAL MARKER
2	BURIED MARKER
0	PUPI ARM
0	EXTENSION ARM
1	NEW HAND HOLE

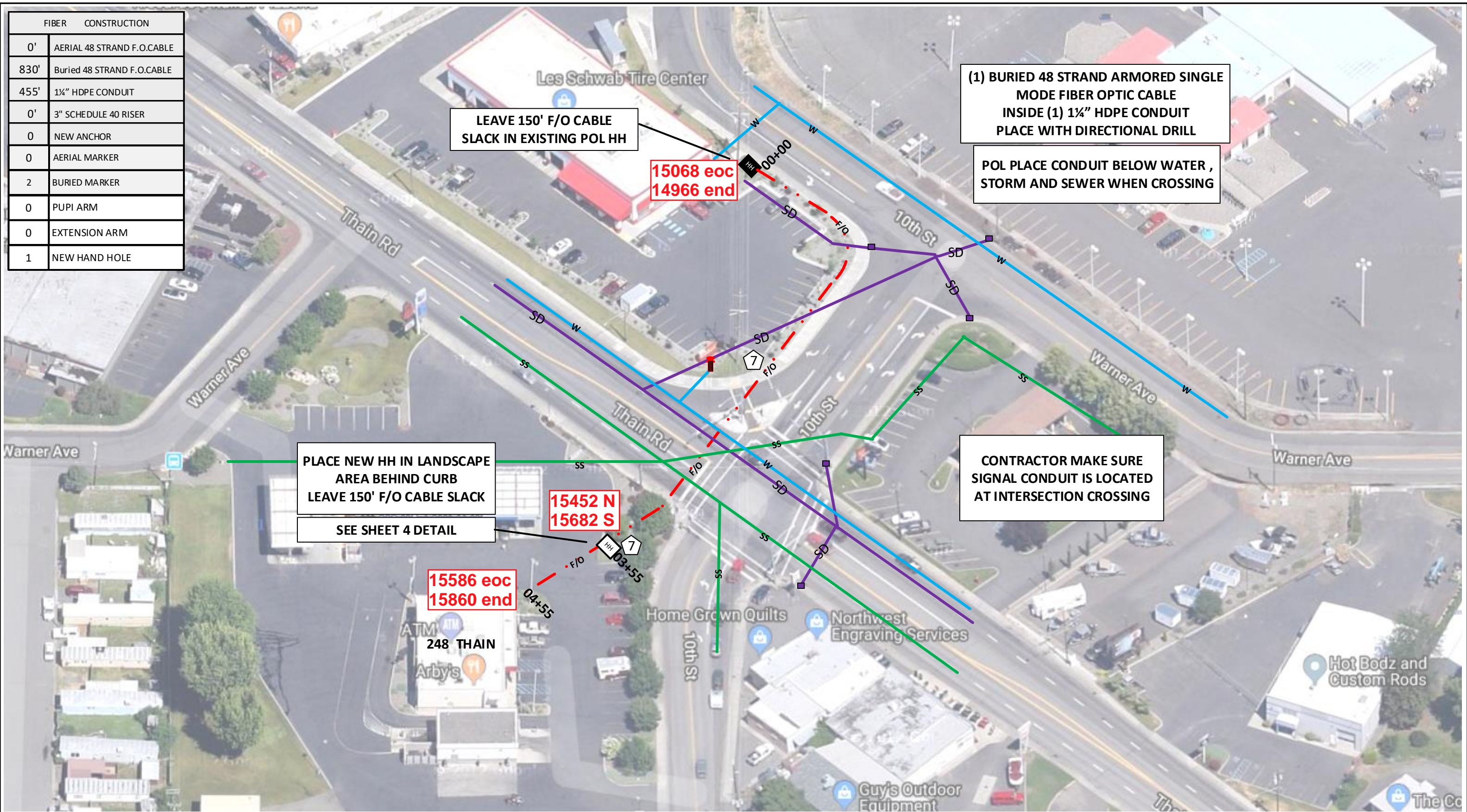

LEAVE 150' F/O CABLE SLACK IN EXISTING POL HH

15068 eoc
14966 end

(1) BURIED 48 STRAND ARMORED SINGLE MODE FIBER OPTIC CABLE INSIDE (1) 1 1/4" HDPE CONDUIT PLACE WITH DIRECTIONAL DRILL

POL PLACE CONDUIT BELOW WATER, STORM AND SEWER WHEN CROSSING

PLACE NEW HH IN LANDSCAPE AREA BEHIND CURB LEAVE 150' F/O CABLE SLACK SEE SHEET 4 DETAIL

15452 N
15682 S

CONTRACTOR MAKE SURE SIGNAL CONDUIT IS LOCATED AT INTERSECTION CROSSING

15586 eoc
15860 end

Drawing Name: Port of Lewiston		Drawn By: Ron Glessner				<table border="1"> <thead> <tr> <th>REV.</th> <th>DESCRIPTION</th> <th>DATE</th> <th>BY</th> </tr> </thead> <tbody> <tr><td> </td><td> </td><td> </td><td> </td></tr> <tr><td> </td><td> </td><td> </td><td> </td></tr> <tr><td> </td><td> </td><td> </td><td> </td></tr> <tr><td> </td><td> </td><td> </td><td> </td></tr> <tr><td> </td><td> </td><td> </td><td> </td></tr> </tbody> </table>				REV.	DESCRIPTION	DATE	BY																					Contact Information Port of Lewiston Dave Doeringsfeld 208-743-5531 Outside Plant Maintenance, llc Ron Glessner 208-661-5648		State: ID County: Nez Perce City: Lewiston Section: Township: Range: Legal:	
REV.	DESCRIPTION	DATE	BY																																		
248 THAIN RD																																					
SIZE	FSCM NO	DWG NO	REV	State: ID County: Nez Perce City: Lewiston																																	
SCALE	SHEET 3		Section: Township: Range: Legal:																																		



**PLACE CONDUIT TO NE CORNER OF BUILDING
 ATTACH 1½" SCH. 40 CONDUIT TO BUILDING
 PENETRATE THROUGH SOFFIT REMOVE
 INTERIOR SUSPENDED CEILING PANELS
 ROUTE CABLE TO OFFICE IN CENTER OF KITCHEN**

**BUILDING CONTACT: MIKE COOPER
 509-751-6491**

Drawing Name:Port of Lewiston	Drawn By: Ron Glessner 09-26-18			
	248 THAIN RD			
	SIZE	FSCM NO	DWG NO	REV
	SCALE		SHEET 4	

REV.	DESCRIPTION	DATE	BY

Contact Information

 Port of Lewiston
 Dave Doeringsfeld
 208-743-5531
 Outside Plant Maintenance, llc
 Ron Glessner 208-661-5648

State: ID
 County: Nez Perce
 City: Lewiston

 Section:
 Township:
 Range:
 Legal:

